

- This document shows how to install your new Truck Guard onto your truck.
- Ensure that you have completely read and understand document **S017 - Safety** before beginning this installation procedure.



Figure 1c: Remove front fasteners (driver side shown)



Figure 1a: Remove fender fasteners (passenger side shown)



Figure 1d: Remove OEM tow loop (driver side shown)



Figure 1b: Remove side fasteners (passenger side shown)

Figure 1: Removing the OEM front bumper

## I. Removing the OEM front bumper

1. Unplug the main harness and detach the block heater cord (if applicable) from the OEM front bumper before removing it.
2. Remove the 6 fender fasteners (3 per side); they can be accessed from in front of the wheels, see Figure 1a.
3. Remove the 4 side fasteners (2 per side) to remove plastic fender covers (1 per side), see Figure 1b.
4. Remove the 6 front fasteners (3 per side). The fasteners' locations are shown in Figure 1c. Remove the OEM front bumper.
5. If the truck comes with OEM tow loops, remove the tow loops together with the bottom fasteners for later usage. If the truck DOES NOT come with OEM tow loops, also remove the bottom fasteners for later usage, see Figure 1d.

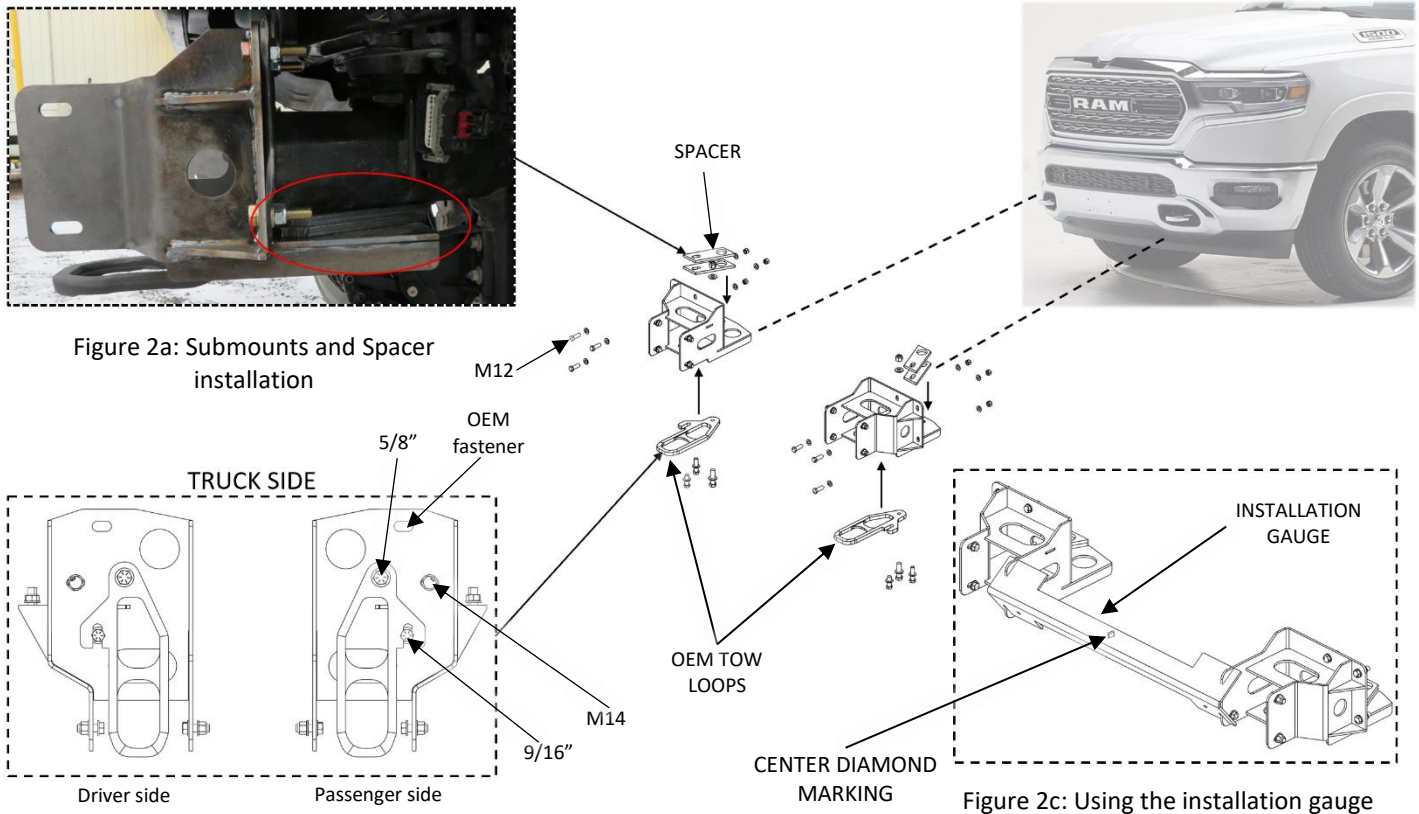

Figure 2a: Submounts and Spacer installation

Figure 2b: OEM tow loops orientation

Figure 2: Installing the submounts

Figure 2c: Using the installation gauge

## II. Installing the submounts

1. Install the Submounts and the Spacers. The Spacers should be placed between the Submounts and the truck frame, see Figure 2a.
2. Install the OEM tow loops (if applicable) to the bottom of the submounts as shown in Figure 2b. Use the provided fasteners (M12) for the front mounting locations. Use the provided fasteners (M14, 9/16", and 5/8") and the OEM bottom fasteners for the bottom mounting locations, see Figure 2b for all fastener's locations. Fasten all fasteners loosely.
3. Use the Installation Gauge to position the Submounts, the center diamond marking should line up with the center of the truck, see Figure 2c.
4. With the Installation Gauge still in position, tighten all mounting fasteners (the bottom fasteners should be tightened first). **Torque the M12 to 84 lb-ft, the M14 to 133 lb-ft, the 9/16" to 138 lb-ft, and the 5/8" to 191 lb-ft.**
5. Remove the installation gauge.

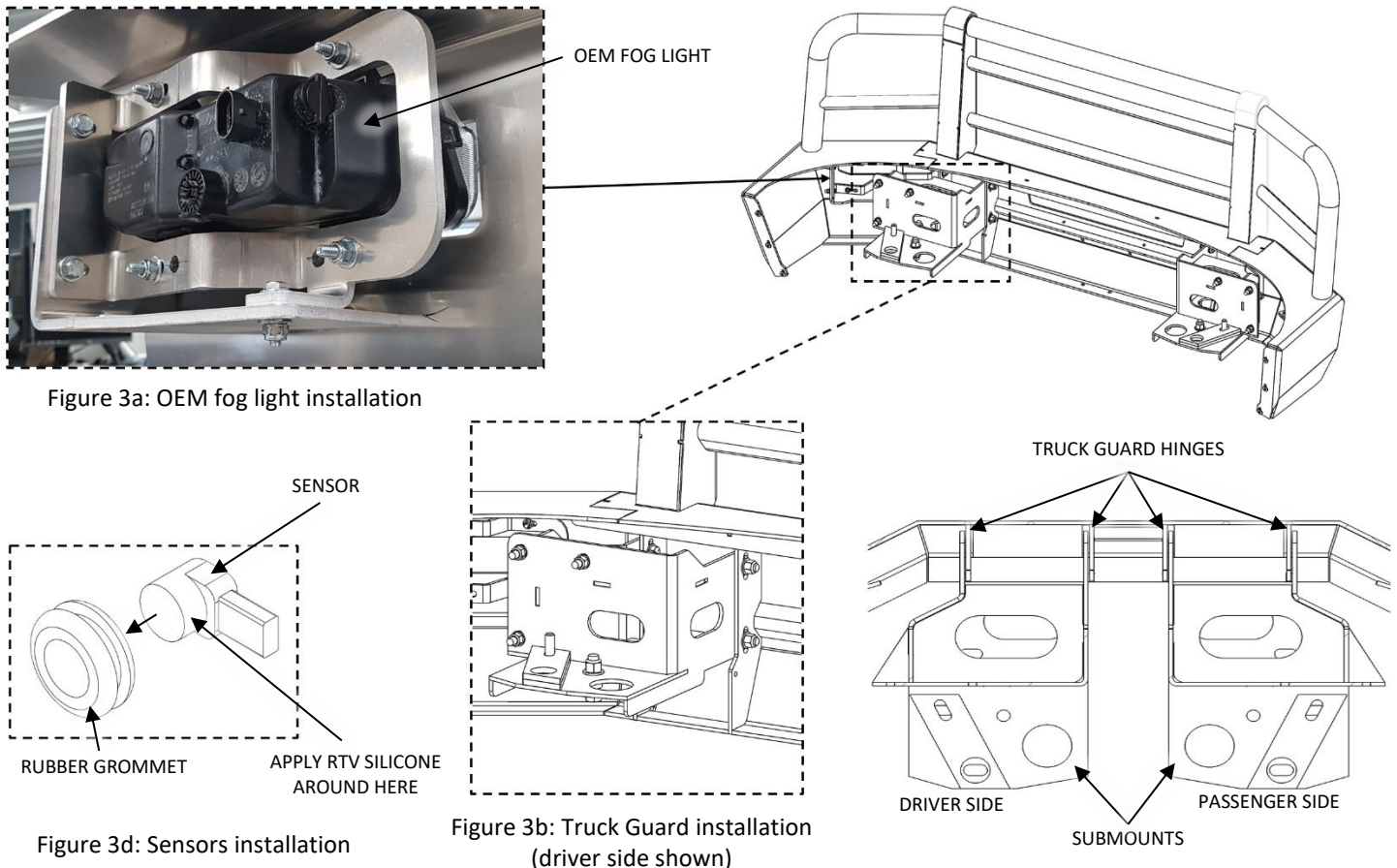

Figure 3: Installing the Truck Guard (view from behind)

### III. Installing the HERD Truck Guard

1. Remove the OEM fog lights from the OEM front bumper (if applicable).
2. Install the OEM fog lights with the provided brackets to the HERD Truck Guard as shown in Figure 3a.
3. Install the HERD Truck Guard to the submounts, **follow the position shown in Figure 3b and Figure 3c**. Adjust the HERD Truck Guard if necessary. Tighten all mounting fasteners (1/2") after adjustment, and **torque to 96 lb-ft**.
4. If the truck has parking sensors, remove them from the OEM front bumper (sensor's bezel is not required) together with wiring harness. Take note of the location of each sensor and harness. Apply RTV silicone all around the cylindrical section of the sensors, then insert the sensors through the rubber grommets on the HERD Truck Guard, see Figure 3d. Ensure locations of the sensors match where they were located on the OEM front bumper.
5. Plug the main harness into each sensor, each fog light, and the truck's wiring harness. Wait until the adhesive cures then check if each sensor functions normally. Clean up loose wiring (main harness and block heater cord) with zip ties.

**Important: Check mounting point's hardware after the first 5000 km and every 3-6 months. Re-torque if necessary.**