

Thank you for choosing HERD!

For assistance call
1-888-543-4373
www.HERD.com

Product	Series
Surface mount signal light	Aero, Aero LT, Defender FLT, Defender, Texas, Big Tex, RT, SRT

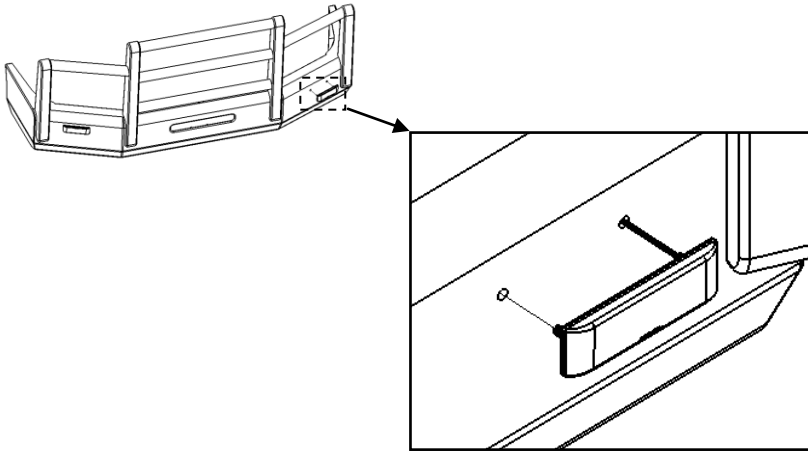

Important

- Herd Bumpers are vehicle "Make & Model" specific. Use of a bumper on a vehicle other than the model it was designed for will constitute improper use of the product and may void warranty.
- Unless otherwise specified, Grade 8 or Class 10.9 hardware is to be used. For the purposes of these instructions, OE hardware means the truck's original factory hardware.
- For further detail of warranty coverage and warranty repair information visit www.HERD.com.

General Safety

- Take time to fully read the instructions before installing the Herd bumper.
- At all times exercise safe work shop practices, wear steel toe boots and safety glasses during installation.
- Parts and components of the Herd bumper can be heavy, handle with care to avoid injuries.
- Respect power tools and use them as advertized.

HERD North America Inc.
2168 Springfield Road
Box 28, Group 525, RR5
Winnipeg, MB. Canada R2C 2Z2

Parts and tools referenced in this instruction

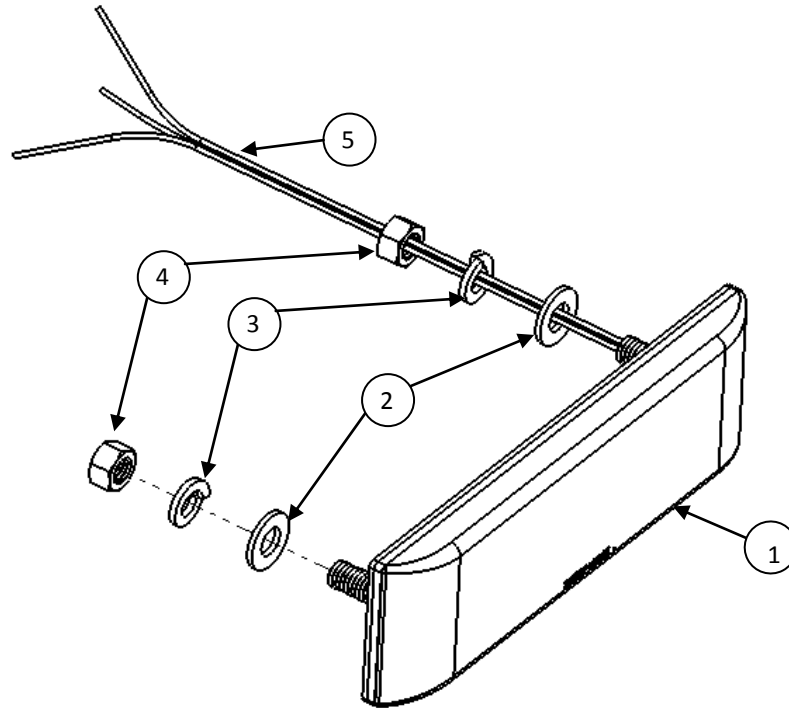

Parts and hardware included

Item No	Part No	Description	Qty
1	4LMP001	LED Light	2
2	FW0.375GR5	Flat Washer - $\frac{3}{8}$ " Grade 5	4
3	HSLW0.375	Spring lock washer - $\frac{3}{8}$ "	4
4	HN0.375-16GR5	Hex Nut - $\frac{3}{8}$ " - 16 Grade 5	4
5	Wires	White - Ground, Red - Turn Signal, Black - Marker light	NA

Tools Required

Tool	Specification
Socket	$\frac{9}{16}$ " or 14 mm
Wrench	$\frac{9}{16}$ " or 14 mm
Drill	
Drill Bit	$\frac{1}{8}$ " and $\frac{1}{2}$ "

Installation Procedure

1. If the Bumper channel contains holes for the signal light.

Unplug pigtails and feed the wires (Item 5) through the hole in the channel. Use 3/8" nuts (Item 4) to mount the light as shown in Figure 1. Tighten nuts until lock washer is flattened, do not over tighten to avoid damage to the light. Connect the pigtails back in. Repeat for the other side.

Wiring:

White – Ground

Red – Turn Signal

Black – Marker light

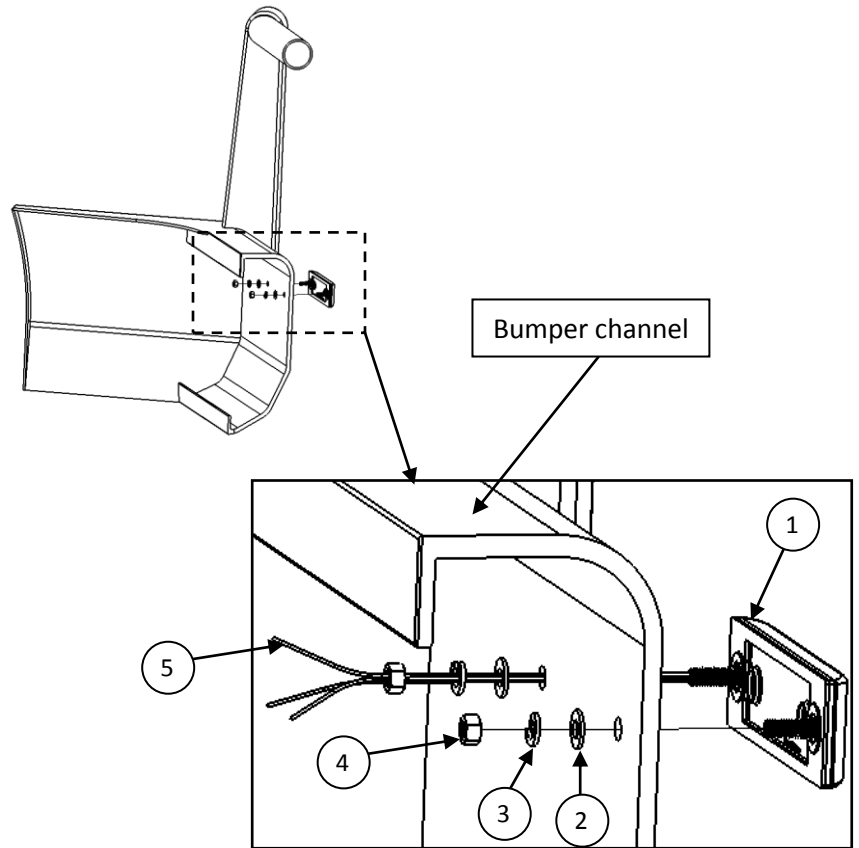

Figure 1

2. No holes in the bumper for the signal light.

Locate two center punched marks in the back of the channel (Figure 2). Drill two 1/2" holes (1/8" pilot hole) using marks for reference. Once holes are drilled install lights as outlined in Step 1.

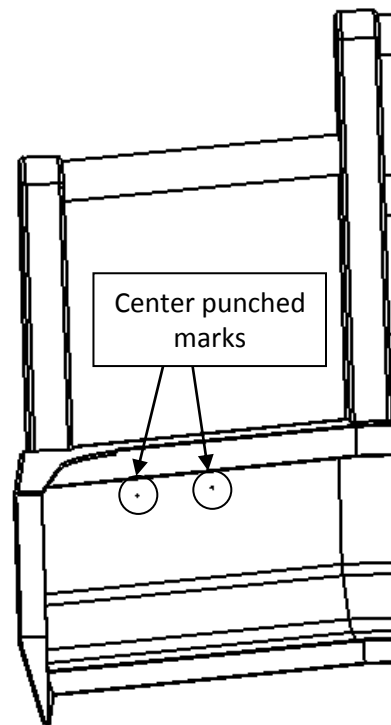

Figure 2

3. If bumper has cut outs for the OEM (factory) driving lights.

Find two center punched marks in the alternative location – usually at the bottom of the bumper (Figure 3). Drill two ½” holes (1/8” pilot hole) using marks for reference. Once holes are drilled install lights as outlined in Step 1.

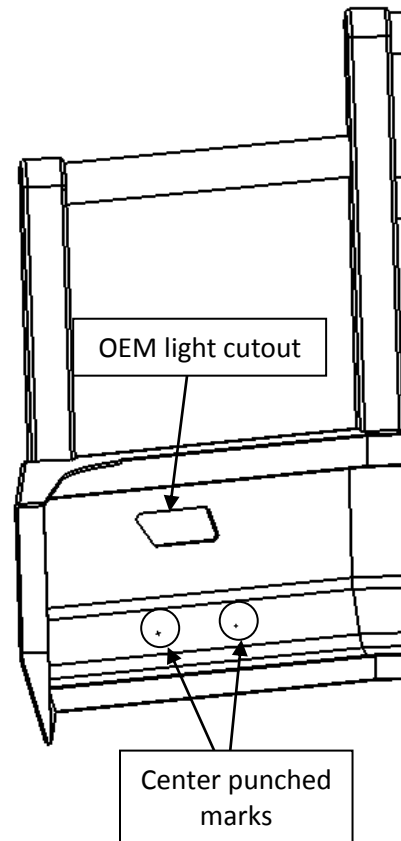

Figure 3